

BF +1,000枚以上 +2,000枚以上 +3,000枚以上 +5,000枚以上 +10,000枚以上

Table of points for BF floor, including columns for 'スパスロ北' and 'スパスロ北' with values ranging from 152 to 158.

Table of points for BF floor, including columns for 'からくり' and 'からくり' with values ranging from 133 to 144.

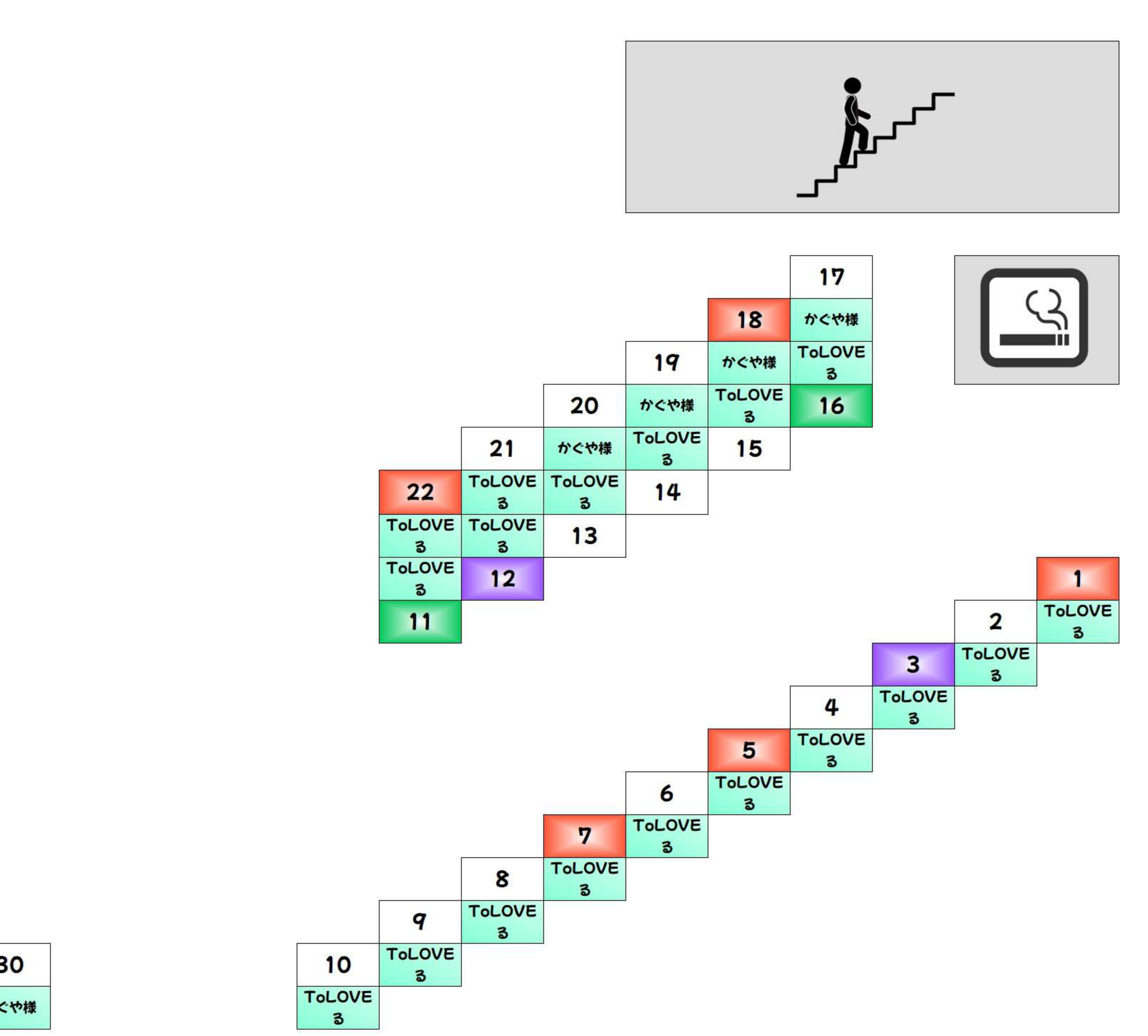

2F +1,000枚以上 +2,000枚以上 +3,000枚以上 +5,000枚以上 +10,000枚以上

Table of points for 2F floor, including columns for 'ハナナリ' and 'ハナナリ' with values ranging from 682 to 692.

Table of points for 2F floor, including columns for 'ファンキー' and 'ファンキー' with values ranging from 729 to 738.

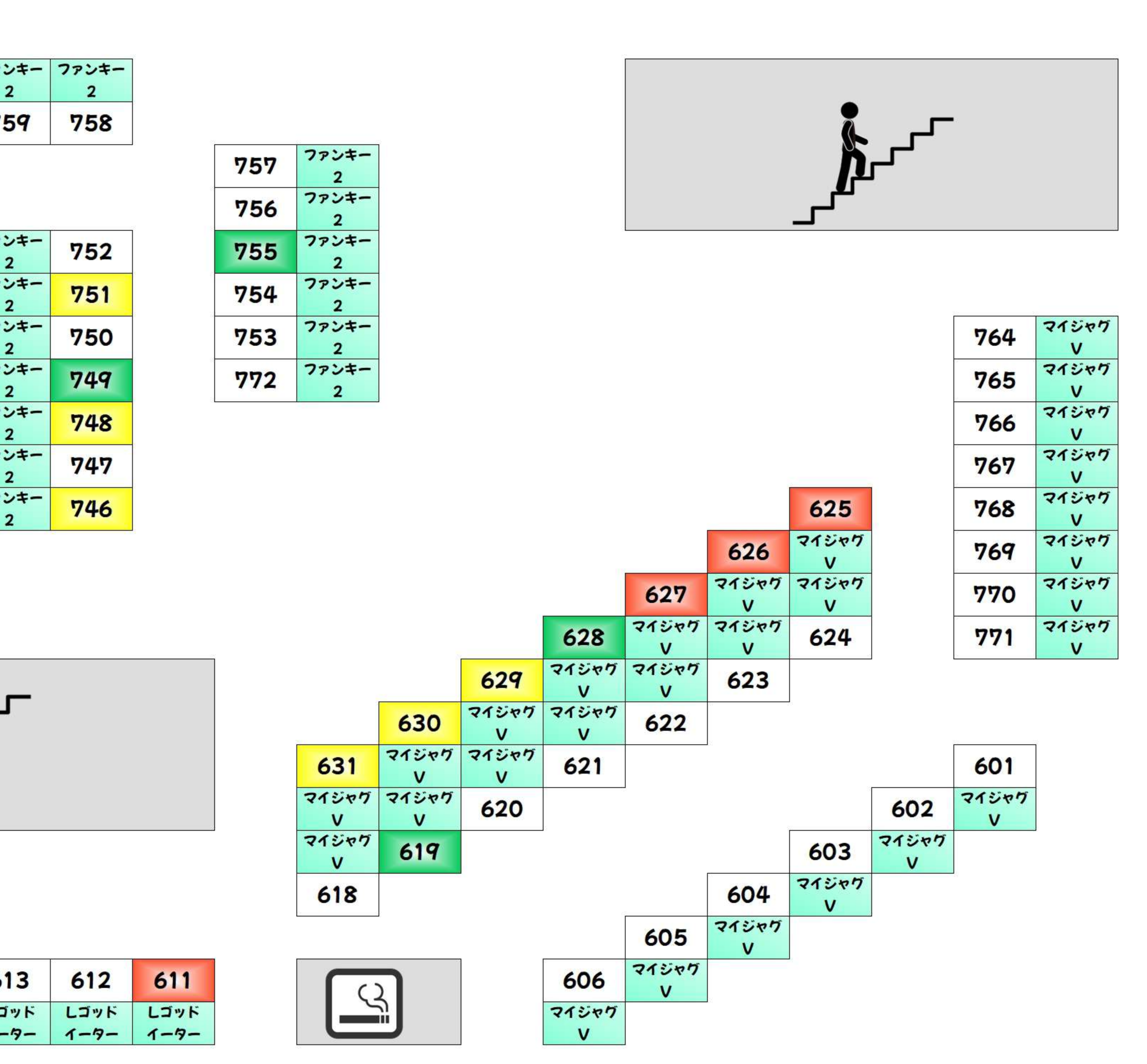

2F +1,000枚以上 +2,000枚以上 +3,000枚以上 +5,000枚以上 +10,000枚以上

Table of points for 2F floor, including columns for 'Re:ゼロ' and 'Re:ゼロ' with values ranging from 801 to 815.

Table of points for 2F floor, including columns for 'マイショウ' and 'マイショウ' with values ranging from 1033 to 1045.



3F +1,000枚以上 +2,000枚以上 +3,000枚以上 +5,000枚以上 +10,000枚以上

Table of points for 3F floor, including columns for 'アイム' and 'アイム' with values ranging from 1084 to 1094.

Table of points for 3F floor, including columns for 'マイショウ' and 'マイショウ' with values ranging from 1033 to 1045.

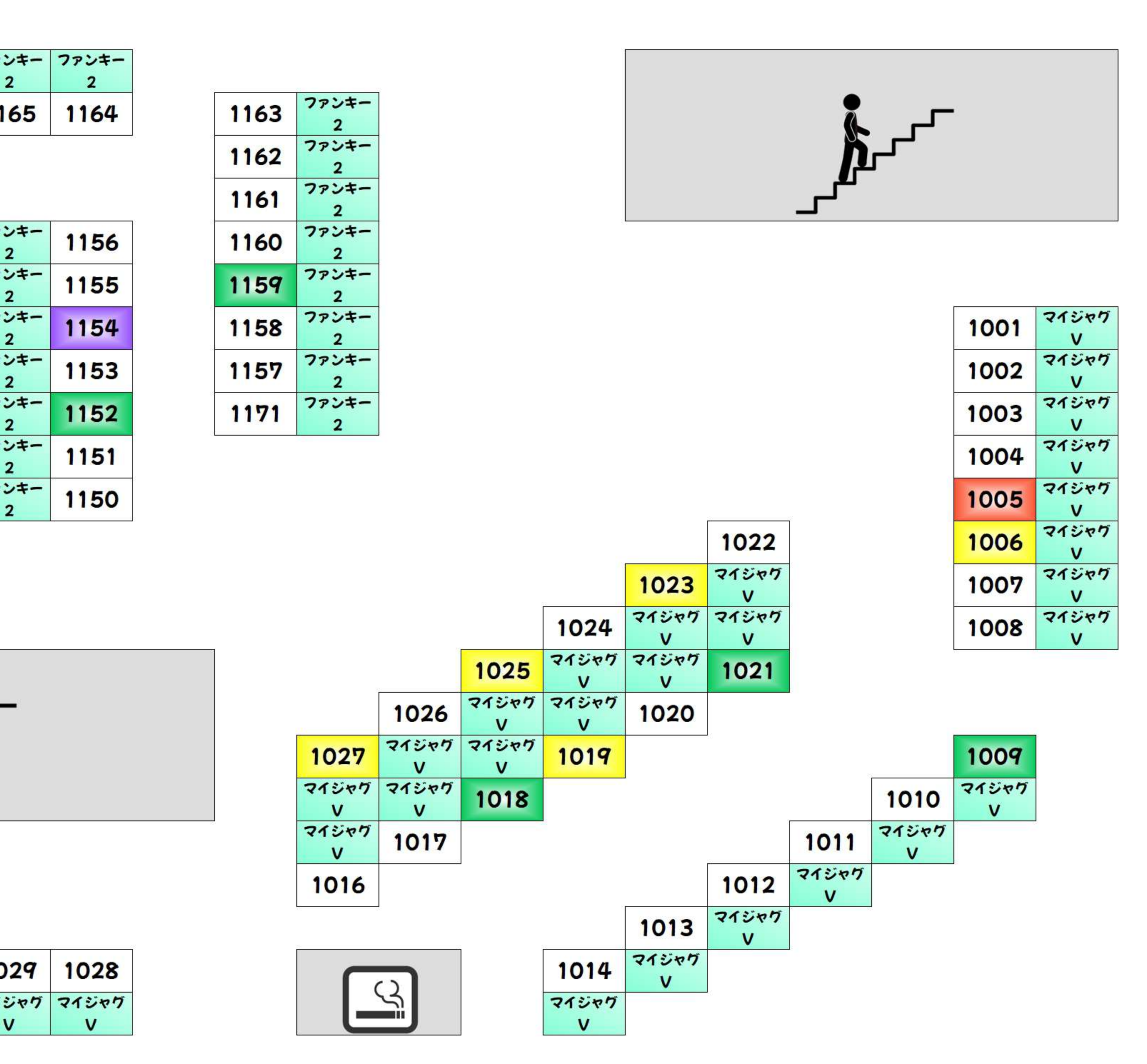

4F +1,000枚以上 +2,000枚以上 +3,000枚以上 +5,000枚以上 +10,000枚以上

Table of points for 4F floor, including columns for '新ハナビ' and '新ハナビ' with values ranging from 1357 to 1385.

Table of points for 4F floor, including columns for 'シンワキ' and 'シンワキ' with values ranging from 1332 to 1342.

